

PERMIT

CITY OF NAPOLEON - BUILDING DEPARTMENT

255 West Riverview Avenue, Napoleon, Ohio 43545 - 419-592-4010

Permit No. 01595 Issued 7-27-88
date

Job Location 1059 Sheffield
address

Lot 5 Bockelman 1st Add
sub-div or legal discript

Issued By Eldon Huber
building official

Owner Dorthy Sonnenberg
name tel.

Address 1059 Sheffield

Agent Rohrs Masonry Inc. 598-8313
builder-eng.-etc. tel.

Address 16-353 Rt. 1 Rd u Nap, OH

Description of Use Residence

Residential 1
no. dwelling units

Commercial _____ Industrial _____

New _____ Add'n. _____ Alter _____ Remodel X

Mixed Occupancy _____

Change of Occupancy _____

Estimated Cost \$ 2300.00

ZONING INFORMATION N/A

district <u>A</u>	lot dimensions		area	front yd	side yds	rear yd
max hgt	no pkg spaces	no ldg spaces	max cover	petition or appeal req'd	date appr	

WORK INFORMATION: N/A

Size: Length _____ Width _____ Stories _____ Ground Floor Area _____

Height _____ Building Volume (for demo. permit) _____ cu. ft.

Electrical: N/A brief description

Plumbing: N/A brief description

Mechanical: N/A brief description

Sign: N/A type Dimensions _____ Sign Area PAID

Additional Information: Tuck point foundation, wall, waterproofing & Stone fill & new footing tile. ALIC 01-1988

Date 8-1-88 Applicant Signature Thomas A. Rohrer owner-agent CITY OF NAPOLEON

FEE	BASE	PLUS	TOTAL
<input checked="" type="checkbox"/> BUILDING	\$9.00	\$18.00	\$27.00
<input type="checkbox"/> ELECTRICAL			
<input type="checkbox"/> PLUMBING			
<input type="checkbox"/> MECHANICAL			
<input type="checkbox"/> DEMOLITION			
<input type="checkbox"/> ZONING			
<input type="checkbox"/> SIGN			
WATER TAP			
<input checked="" type="checkbox"/> SEWER TAP	60.00		60.00
TEMP. ELECT.			
ADDITIONAL PLAN REVIEW	Struct. _____ hrs	Elect. _____ hrs	
TOTAL FEES.....			\$27.00 87.00
LESS MIN. FEES PAID _____			
BALANCE DUE.....			

PERMIT

CITY OF NAPOLEON - BUILDING DEPARTMENT

01595 255 West Riverview Avenue, Napoleon, Ohio 43545 - 419-592-4010

Permit No. Issued 7-27-88
date

Job Location 1059 SHEFIELD
address

Lot 5 DICKELMAN 157 ADD
sub-div or legal discript

Issued By EH
building official

Owner DOROTHY SONNENBERG
name tel.

Address 1059 SHEFIELD

Agent ROADS MASOURY INC. 598-8313
builder-eng -etc. tel.

Address 16-353 RT 1 RD U
NAP. OHIO

Description of Use RESIDENTIAL

Residential 1 no. dwelling units

Commercial Industrial

New Add'n. Alter Remodel X

Mixed Occupancy

Change of Occupancy

Estimated Cost \$ 2300.00

FEES	BASE	PLUS	TOTAL
<input checked="" type="checkbox"/> BUILDING	9. ⁰⁰	18. ⁰⁰	27. ⁰⁰
<input type="checkbox"/> ELECTRICAL			
<input type="checkbox"/> PLUMBING			
<input type="checkbox"/> MECHANICAL			
<input type="checkbox"/> DEMOLITION			
<input type="checkbox"/> ZONING			
<input type="checkbox"/> SIGN			
WATER TAP			
SEWER TAP			
TEMP. ELECT.			
ADDITIONAL PLAN REVIEW	Struct. <u> </u> hrs		
	Elect. <u> </u> hrs		
TOTAL FEES.....			27. ⁰⁰
LESS MIN. FEES PAID <u> </u>			
	<small>date</small>		
BALANCE DUE.....			

ZONING INFORMATION NA

district	lot dimensions	area	front yd	side yds	rear yd
<u>A</u>					
max hgt	no pkg spaces	no ldg spaces	max cover	petition or appeal req'd	date appr

WORK INFORMATION: NA

Size: Length Width Stories Ground Floor Area

Height Building Volume (for demo. permit) cu. ft.

Electrical: NA brief description

Plumbing: NA brief description

Mechanical: NA brief description

Sign: NA Dimensions Sign Area

type

Additional Information: TOLK POINT FOUNDATION & WALLS, WATERPROOFING + STONE FLIC & NEW FOOTING TILE

Date Applicant Signature owner-agent

CITY OF NAPOLEON
BUILDING INSPECTION DEPARTMENT
APPLICATION FOR BUILDING PERMIT
(Please print or type)

The undersigned hereby makes application for construction, installation, or alteration work as herein specified, agreeing to do all such work in strict accordance with the City of Napoleon's adopted Building Codes.

Location of project 1059 Sheffield Cost of project 2,300.⁰⁰
Owner's Name Dorothy Sonnenberg Address 1059 Sheffield
Contractor Robis Masonry Inc. Telephone No. 598-8313
Address 16-353 RT1 Rd U Napoleon

Lot Information: (Not required for siding job)

Lot No. _____ Subdivision _____
Zoning District _____ Lot Size _____ ft. X _____ ft. Area _____ sq. ft.
Setbacks: Front _____ Right Side _____ Left Side _____ Rear _____

Work Information:

Residential X Commercial _____ Industrial _____
New Construction _____ Addition _____ Remodel _____
Accessory Building _____ Siding _____

Brief Description of Work:----- TRUCK POINT WALLS, STONE FILL
NEW TILE

Size: Length _____ Width _____ No. of Stories _____
Area: 1st Floor _____ sq. ft. Basement _____ sq. ft.
2nd Floor _____ sq. ft. Accessory Bldg. _____ sq. ft.
3rd Floor _____ sq. ft. Other _____ sq. ft.

Additional Information: _____

APPLICATION FOR PERMIT SHALL BE ACCOMPANIED BY TWO COMPLETE SETS OF PLANS INCLUDING: ELEVATIONS, FLOOR PLANS, CROSS SECTIONS AND PLOT PLAN. IF ADDITION OR REMODELING, SHOW ALL EXISTING STRUCTURES AND THEIR SIZE AND LOCATION. ALL PLANS SHALL BE DRAWN TO SCALE.

Date _____ Applicant's Signature Thomas a Robis

PERMIT NO.

PERMIT FEE \$



APPLICATION FOR PERMIT TO TAP SEWER

Owner R DORTHY SOMMERS
ADDRESS 1059 SHEFFIELD
CONTRACTOR ROARS MASONRY
ADDRESS 16-553 RT 1 RD U TEL. 598-8313
MAP OHIO

NO. SR 0067.88
BLDG. PERMIT NONE
PERMIT FEE \$ 60.⁰⁰
INSTRUCTION
STREET BOND NONE
DATE PAID 7-28-88
For office use only

LOCATION OF CONNECTION

Street and No. 1059 SHEFFIELD Sanitary Storm
Lot No. 5 Subdivision ROCKELMAN 157 Size of Tap 4
Size and Type of Sewer 4" SDR 35 ALL WORK MUST BE INSPECTED
Street to be opened-Yes No Opening bond fee set by Engineer \$
Street opening agreement approval date NONE

I certify that the sewer will be used only as indicated and no other drainage will be connected.

Date 7-27-88 Signature Thomas A. Rohrer
Owner-Builder-Agent

DO NOT WRITE BELOW THIS LINE

INSPECTION RECORD

Date Inspected 8-7-88 Size and Type of Sewer 4" S.D.R. 35
Location SEE SITE PLAN Depth 4.5' Type of Test NONE
Inspected and Approved by: M. HELBERG 10-24-88
Inspector Date

Additional information

Send copy to:

SKETCH OF INSTALLATION - ON BACK

30' center Rd

CITY OF NAPOLEON
ENGINEERING DEPT.
255 W RIVERVIEW
NAPOLEON, OH 43545

SHEET NO 1059 SHEFIELD
CALCULATED BY TAP NO 57 0068-88 DATE
CHECKED BY M. HELBERG DATE 8-3-88
SCALE

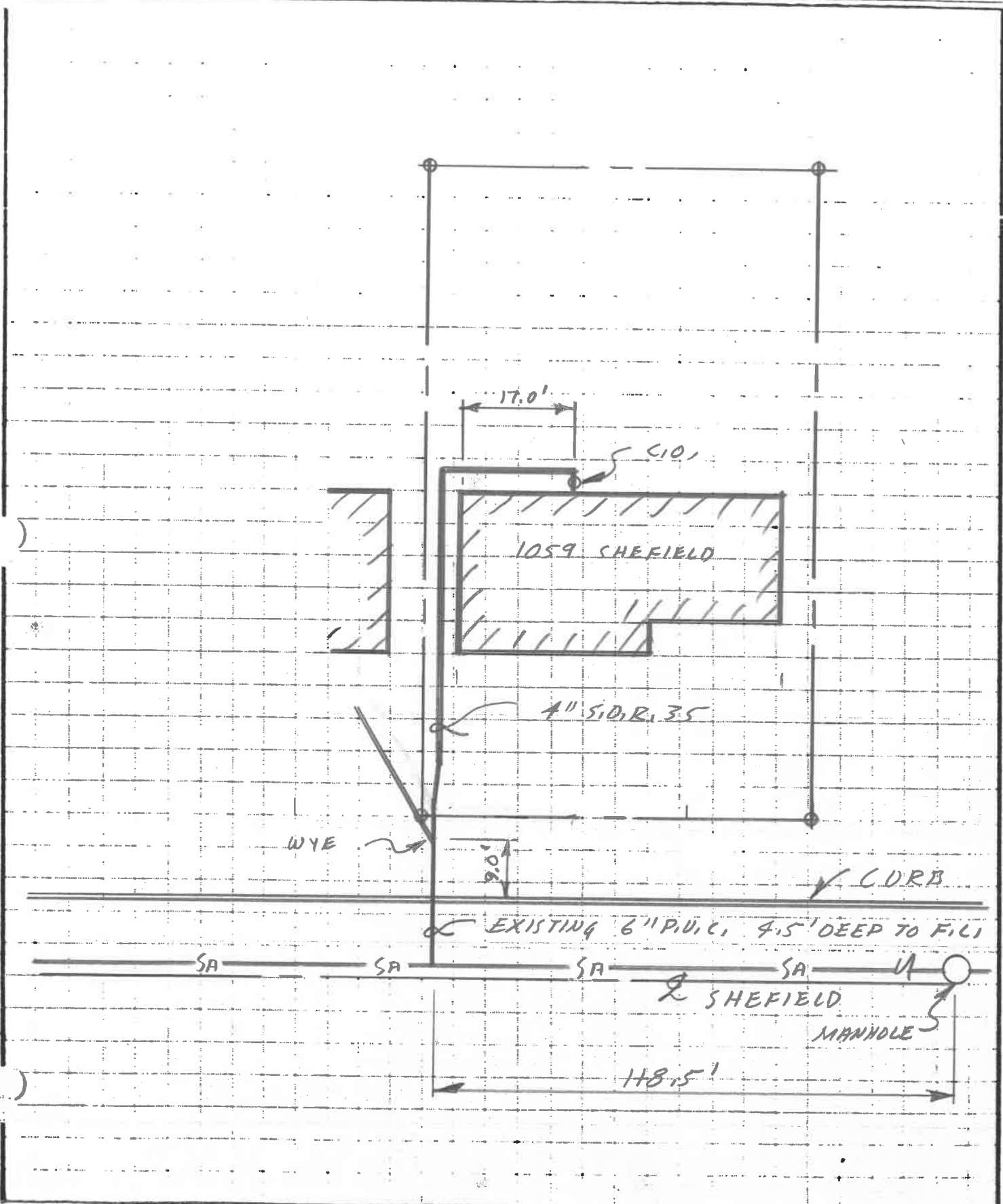

N

8-3-88 inspected on

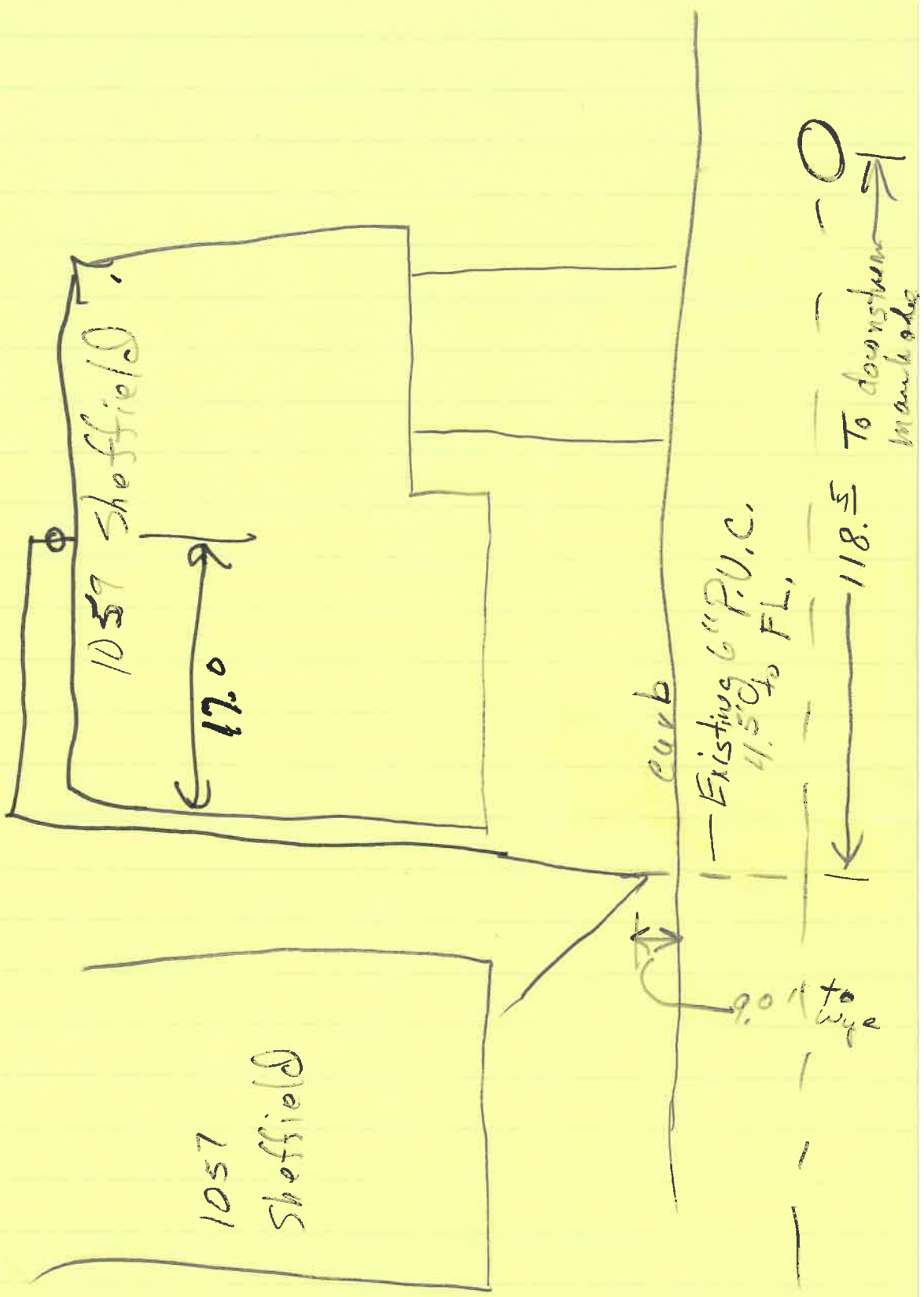

1059 SHEFFIELD

THIS LINE

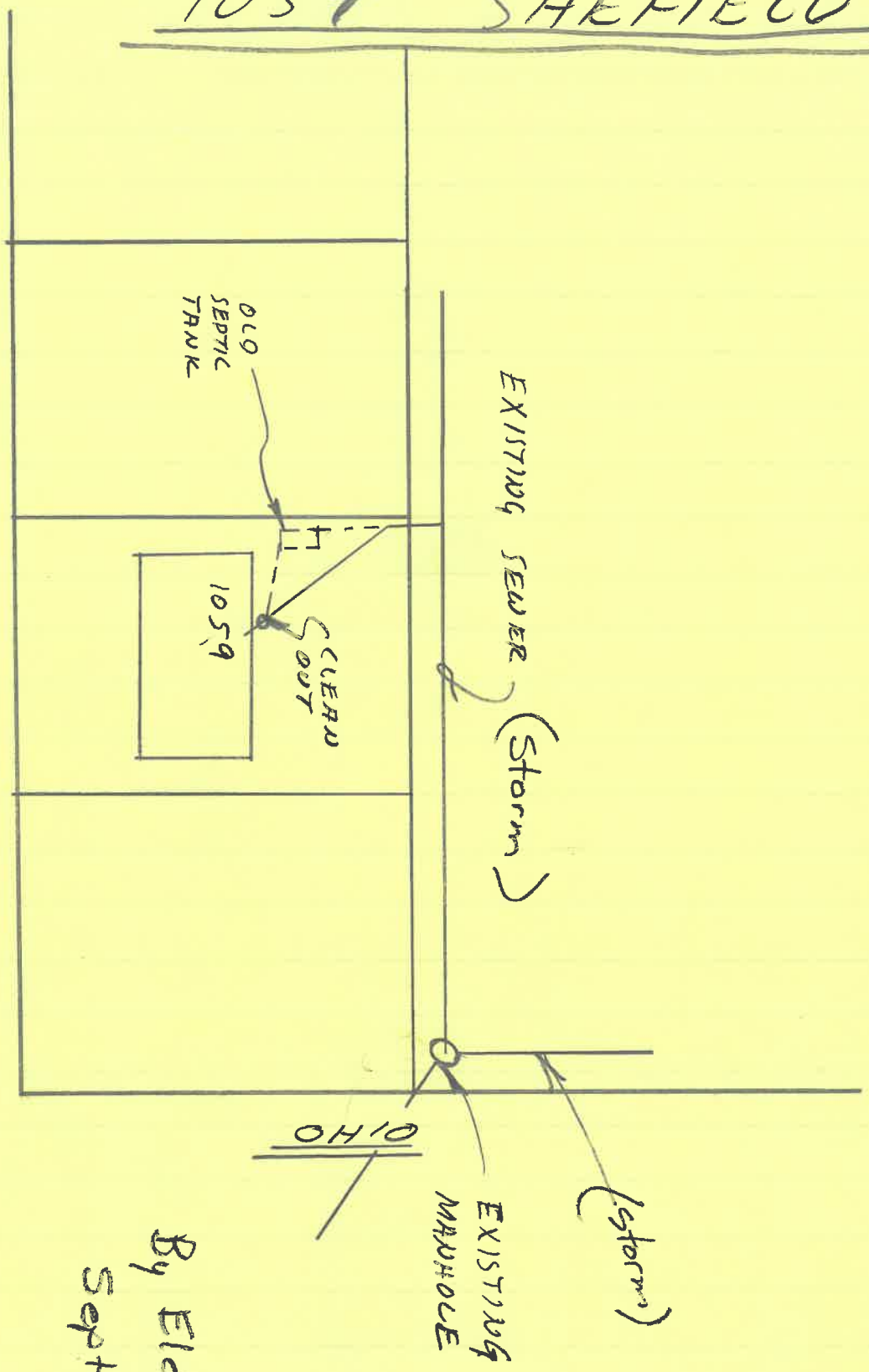

SHEFFIELD

By Eldon Huber
Sept. 1987

SHEFFIELD ST

Notes By

Sonny Helberg

Sept. 1987

OHIO ST.

